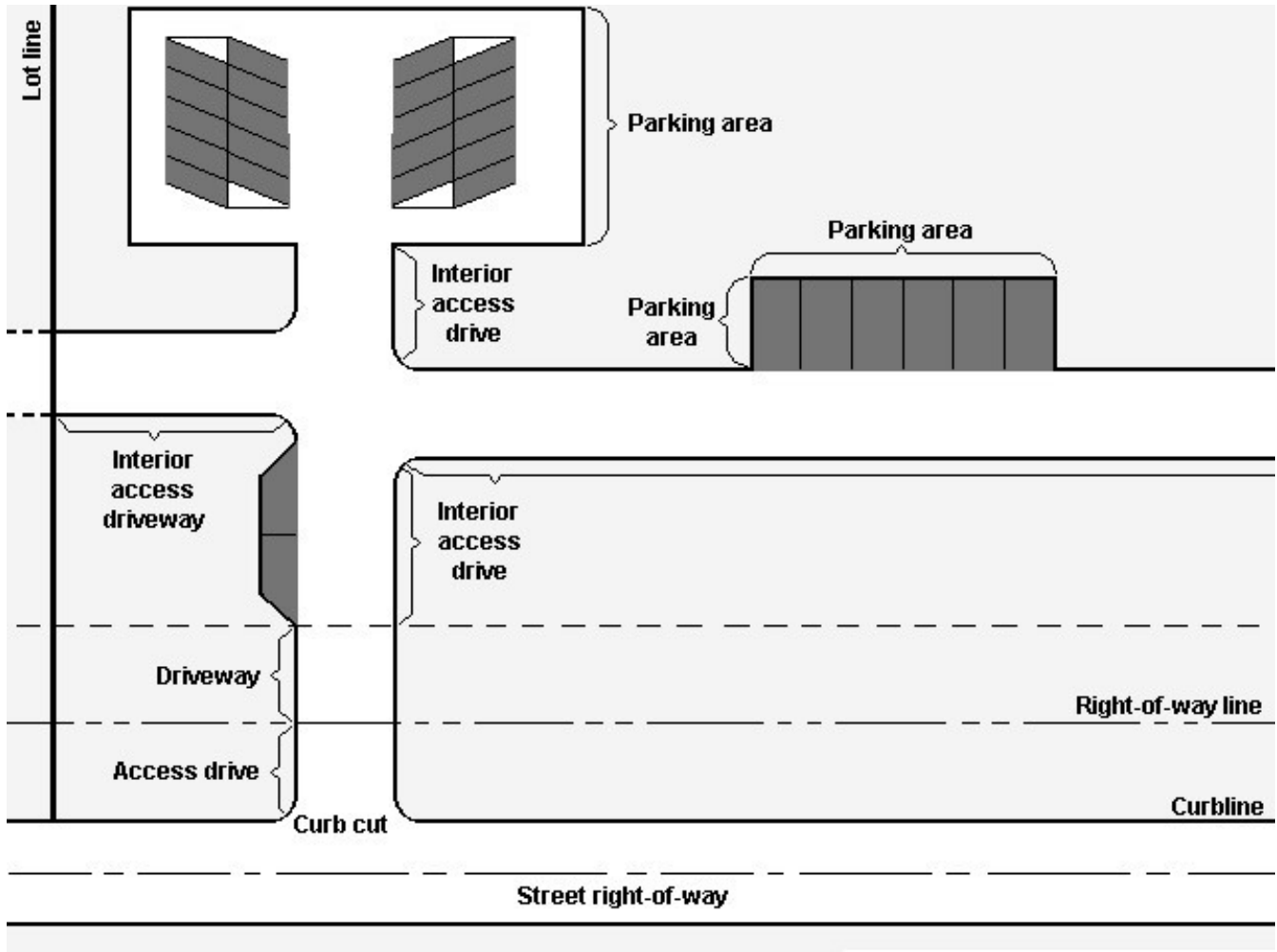

Diagram A

Vehicle Areas



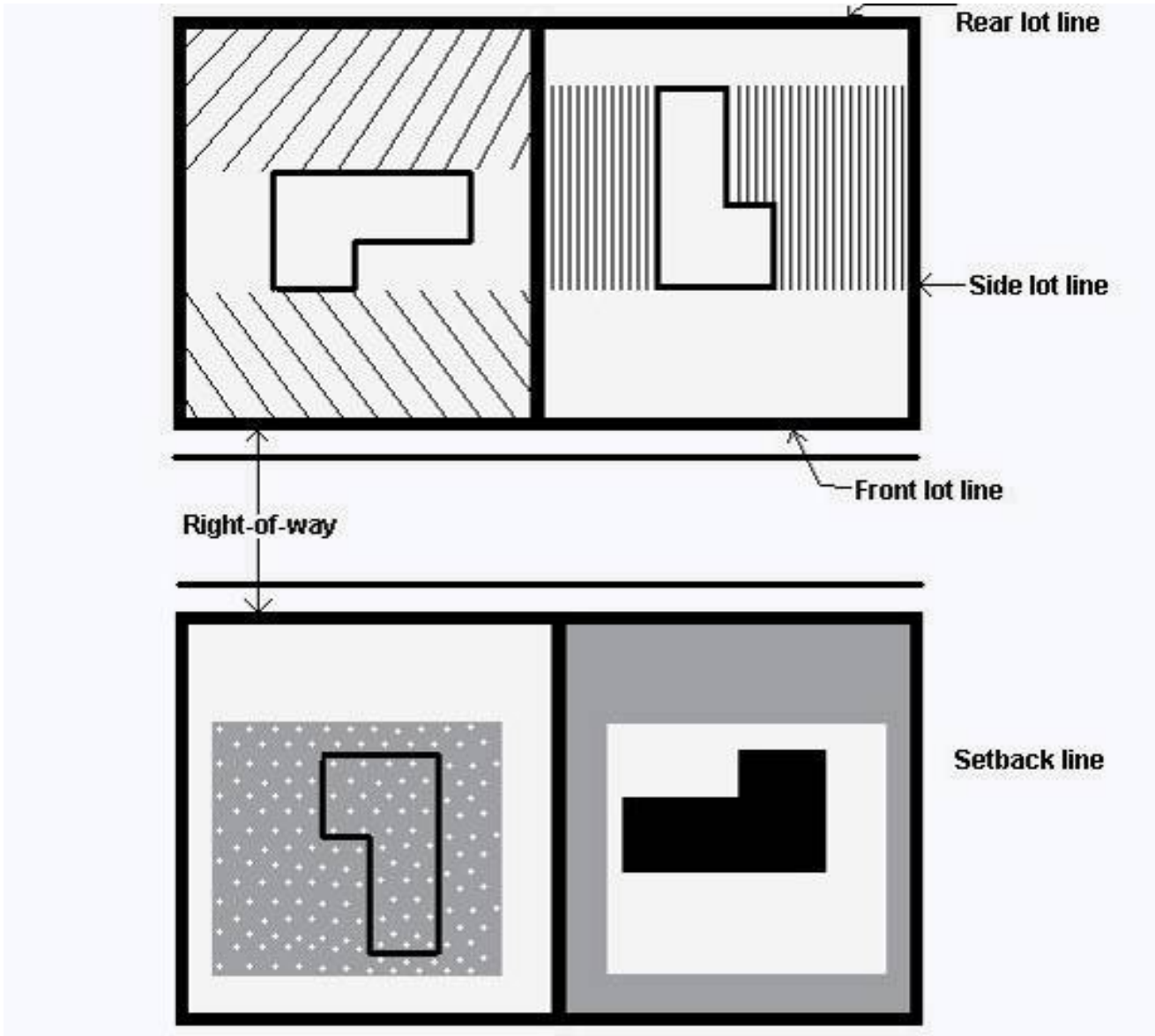
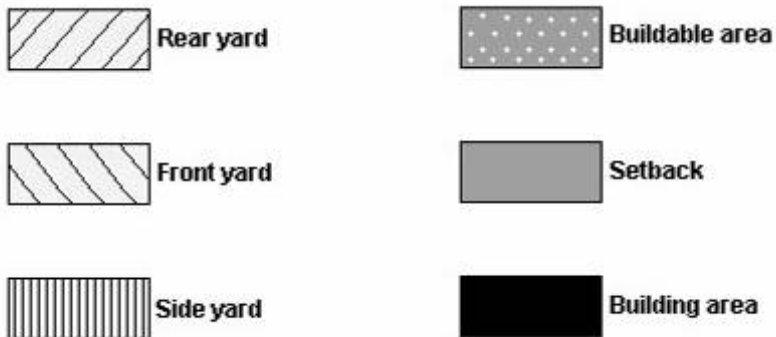

Diagram B

Components of a Lot



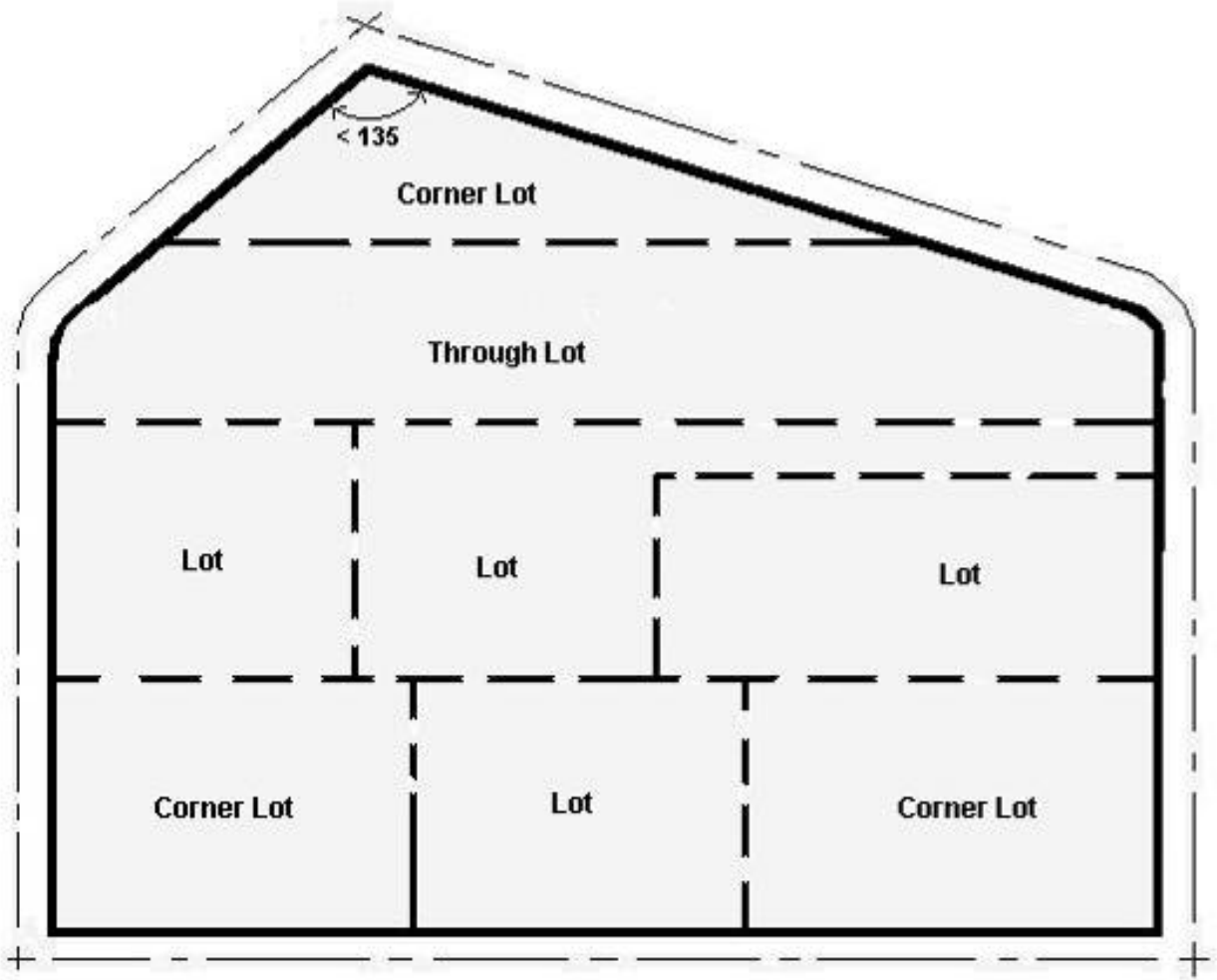

Diagram C

Types of Lots

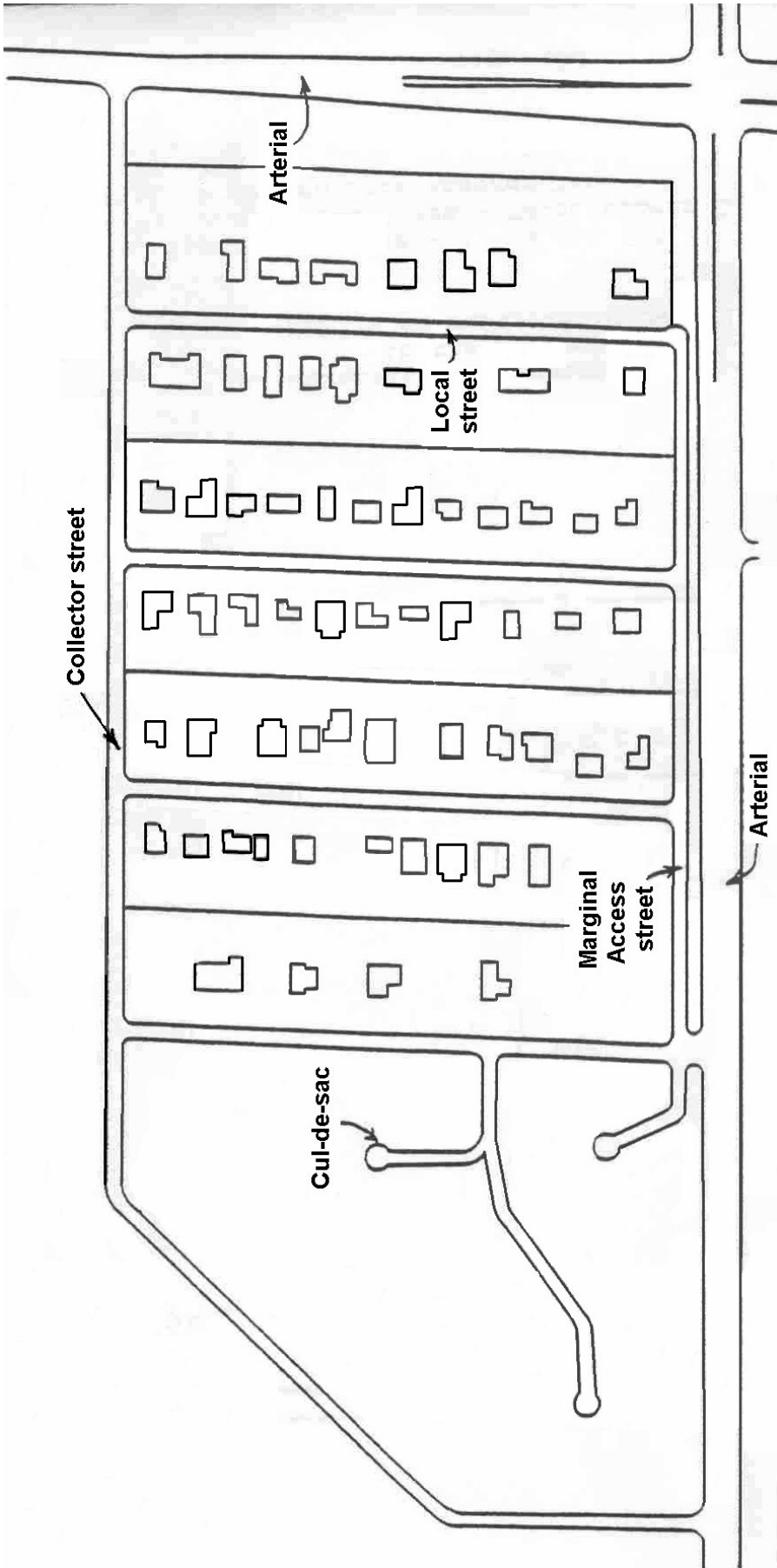

Diagram D

Types of Streets

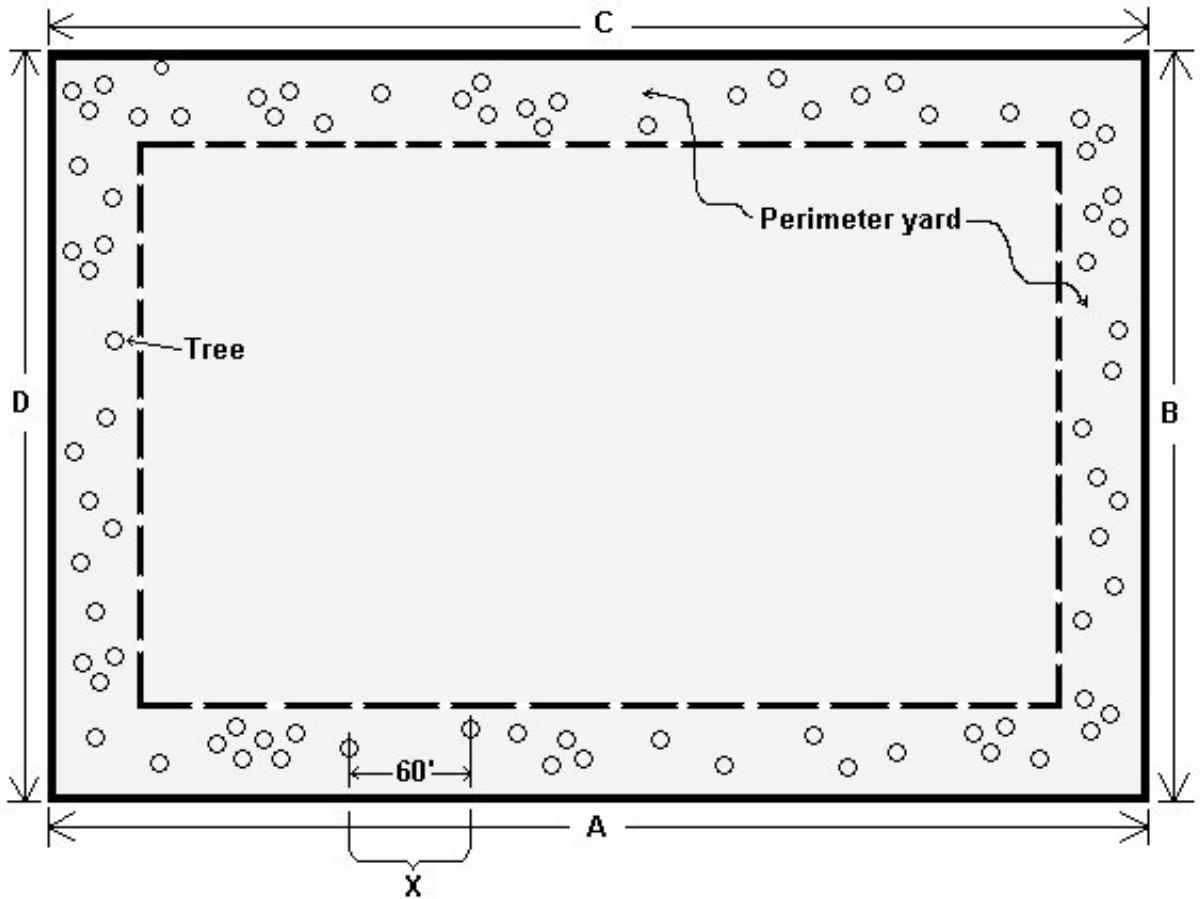
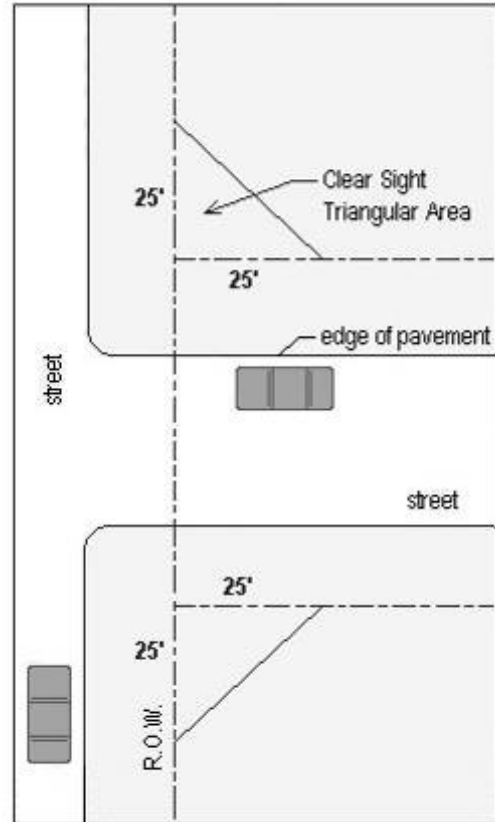
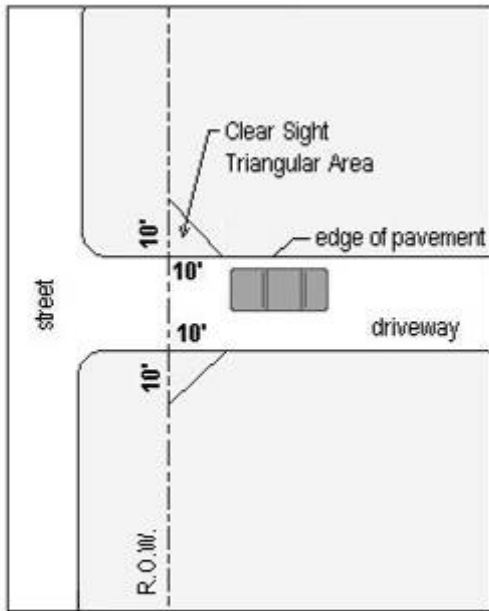

Diagram E

**Measurement and Computation of Required Trees
In the Perimeter Yard of a
Mobile or Multifamily Dwelling Project**

**Total Linear Distance = $A + B + C + D$
Number of Required Trees = Total Linear Distance / 20
Maximum Distance from another tree = X**

Diagram F



Clear Sight Triangular Area Examples No Scale

Fence Requirements

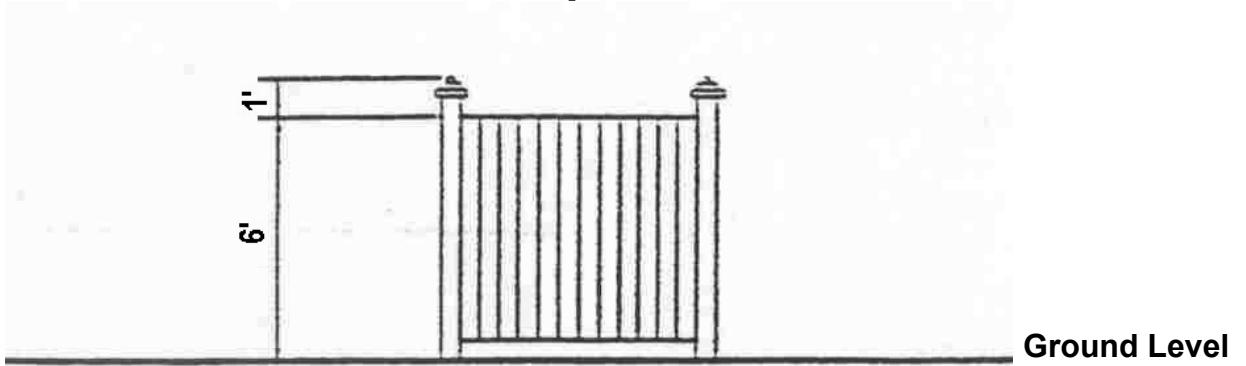

Diagram G

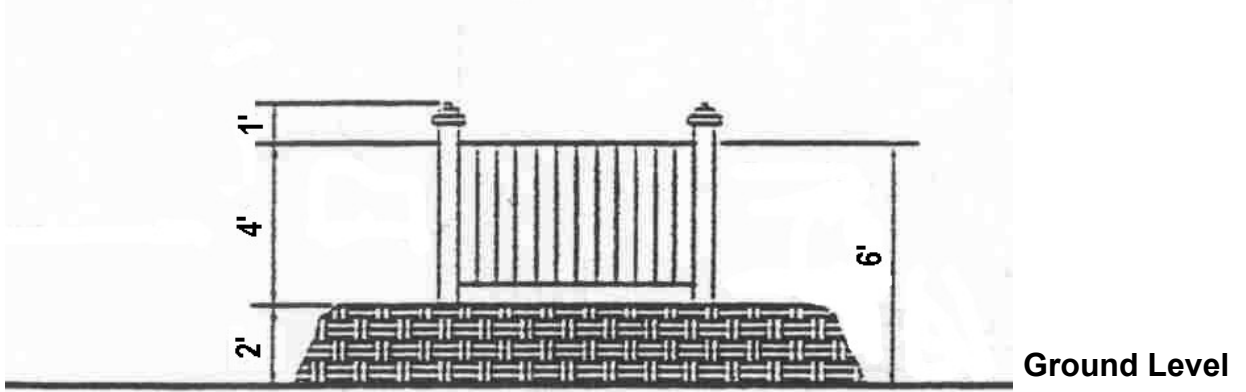

Diagram H

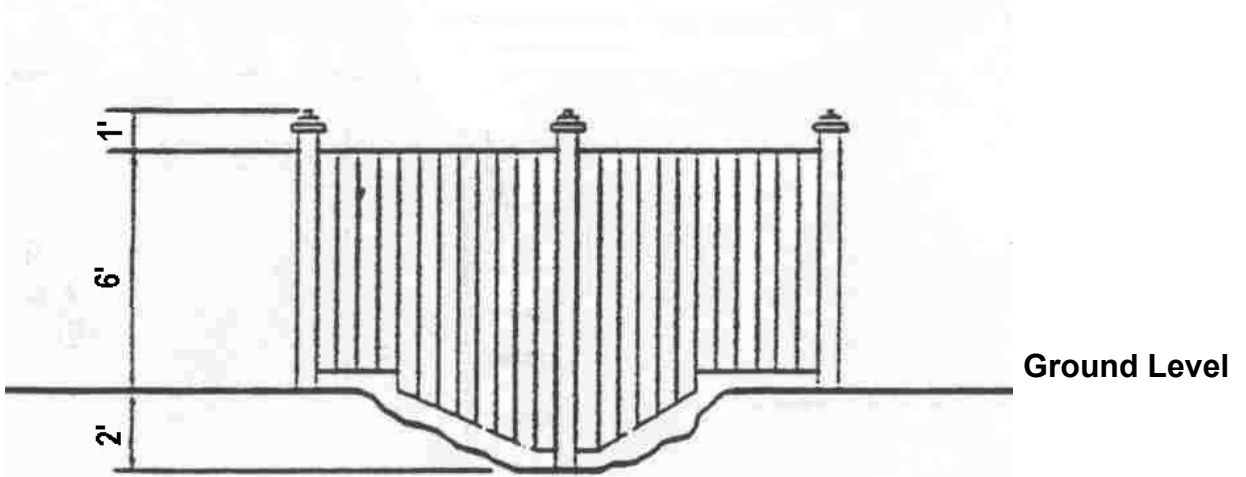
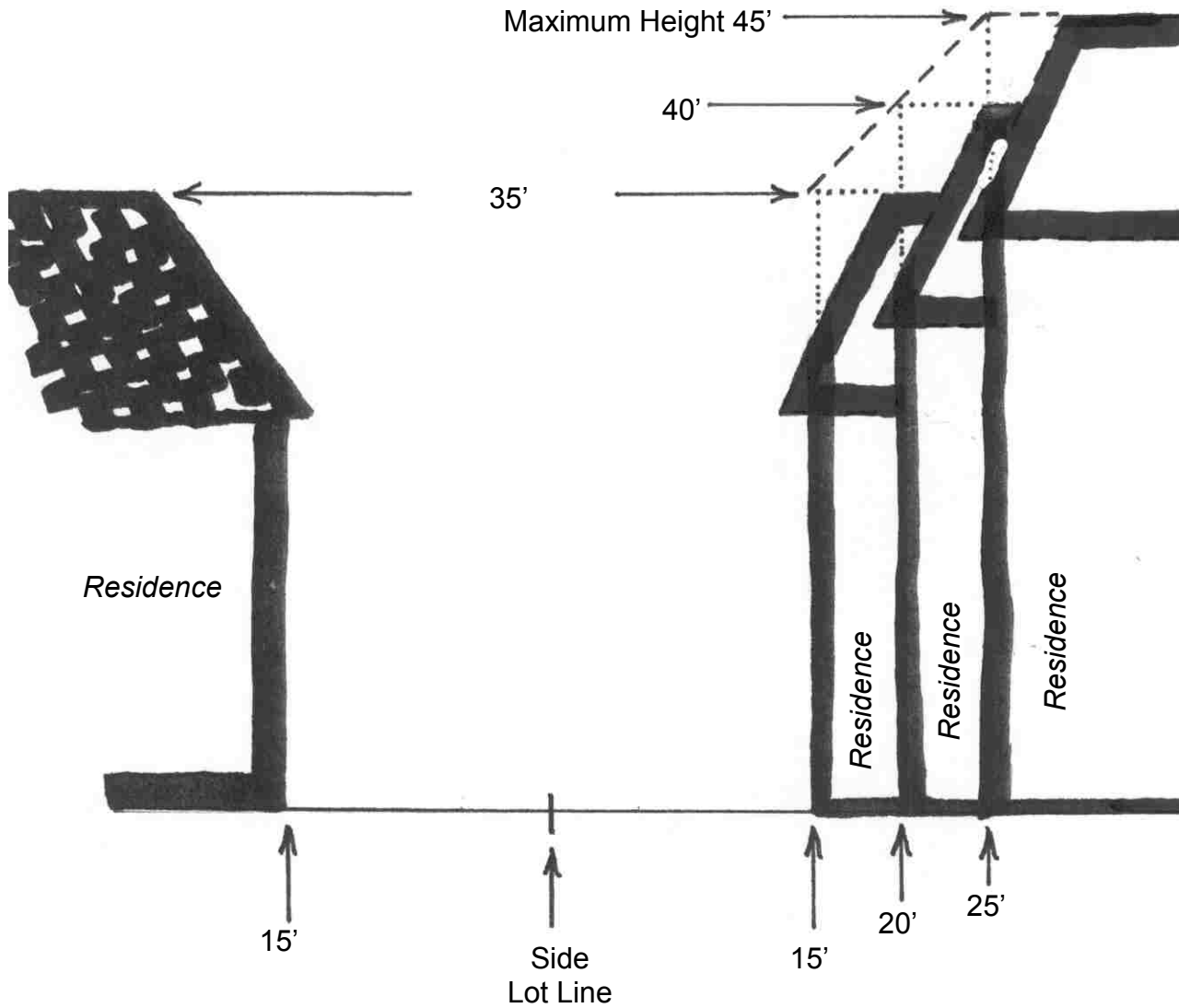

Diagram I

Diagram K

Building Setback / Height Ratio Building Setbacks / Building Height



D-A, D-S, D-1 Districts
(D-S District used as an example in this graphic)

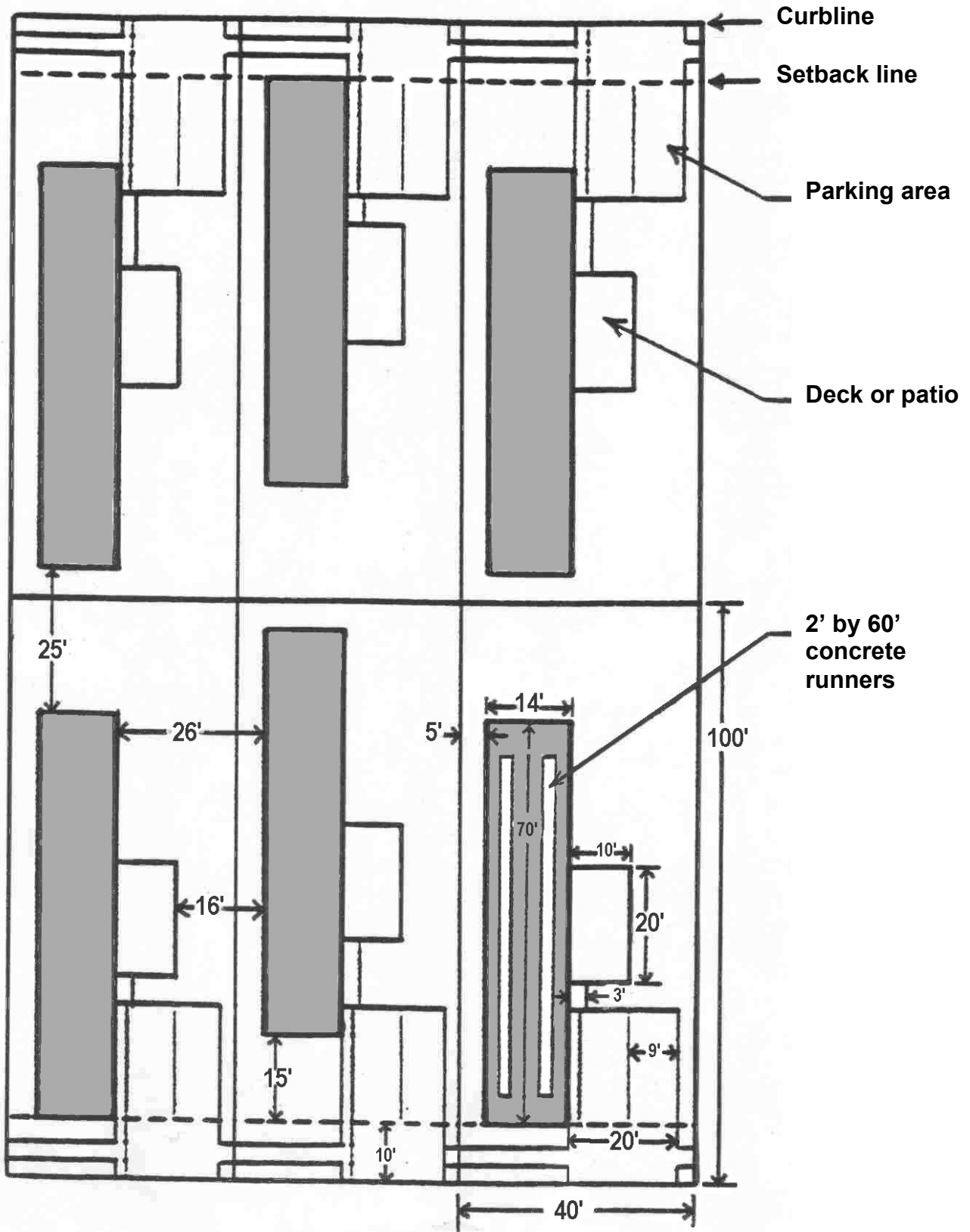

Diagram L
Typical Mobile Dwelling Sites
Site = 4,000 sq. ft.

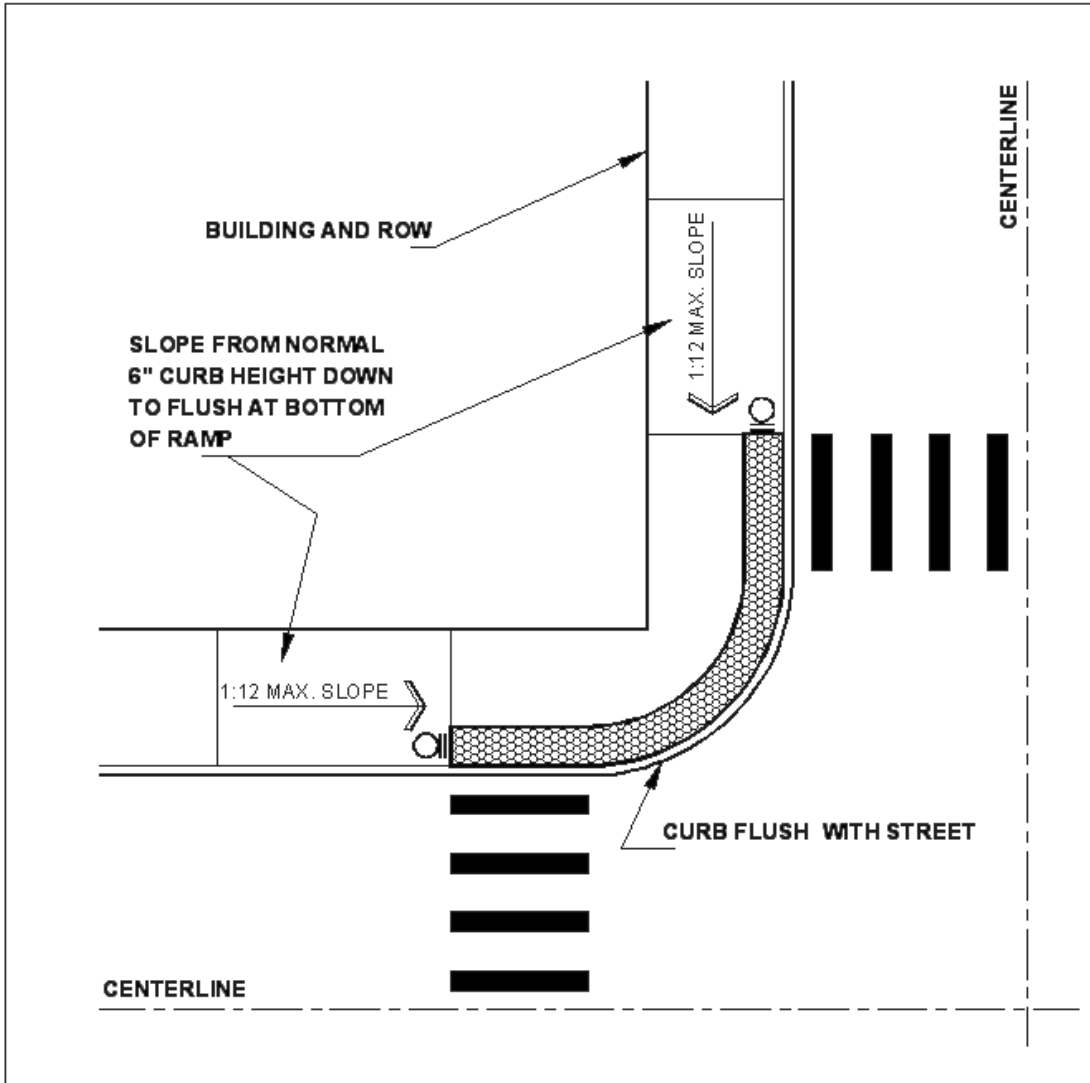

Diagram M
Blended Transition

Summary of Selected Development Standards Single and Two-family Dwelling Districts

| District | Minimum Lot Area | | Minimum Lot Width | | Minimum Street Frontage | Minimum Rear Yard | Minimum Side Yard | | Minimum Open Space | Minimum Main Floor Area | |
|--------------|------------------|----------------|-------------------|------------|-------------------------|-------------------|-------------------|-----------|--------------------|-------------------------|---------------|
| | Single-family | Two-family | Single-family | Two-family | | | 1-side | Aggregate | | 1-story | Above 1-story |
| D-A | 3 acres | | 250 feet | | 125 feet | 75 feet | 30 feet | 75 feet | 85% | 1200 sq. ft. | 800 sq. ft. |
| D-S | 1 acre | | 150 feet | | 75 feet | 25 feet | 15 feet | 35 feet | 85% | 1200 sq. ft. | 800 sq. ft. |
| D-1 | 24,000 sq. ft. | | 90 feet | | 45 feet | 25 feet | 8 feet | 22 feet | 80% | 1200 sq. ft. | 800 sq. ft. |
| D-2 | 15,000 sq. ft. | 20,000 sq. ft. | 80 feet | 120 feet | 40 feet | 25 feet | 7 feet | 19 feet | 75% | 1200 sq. ft. | 800 sq. ft. |
| D-3 | 10,000 sq. ft. | 15,000 sq. ft. | 70 feet | 105 feet | 35 feet | 20 feet | 6 feet | 16 feet | 70% | 1200 sq. ft. | 800 sq. ft. |
| D-4 | 7,200 sq. ft. | 10,000 sq. ft. | 60 feet | 90 feet | 30 feet | 20 feet | 5 feet | 13 feet | 65% | 900 sq. ft. | 660 sq. ft. |
| D-5 | 5,000 sq. ft. | 9,000 sq. ft. | 50 feet | 90 feet | 25 feet | 20 feet | 4 feet | 10 feet | 65% | 900 sq. ft. | 660 sq. ft. |
| D-5II | 3,200 sq. ft. | 7,600 sq. ft. | 40 feet | 80 feet | 25 feet | 10 feet | 3 feet | 10 feet | 65% | 900 sq. ft. | 660 sq. ft. |
| D-8 | N/A | | 30 feet | | 30 feet | 15 feet | 4 feet | 10 feet | 55% | 900 sq. ft. | 660 sq. ft. |
| D-12 | 9,000 sq. ft. | | 70 feet | | 35 feet | 20 feet | 4 feet | 10 feet | 65% | 900 sq. ft. | 660 sq. ft. |

Notes:

1. Two (2) off-street parking spaces shall be provided for each dwelling unit.
2. A maximum height of 35 feet for primary buildings and 20 feet for accessory buildings applies
3. Minimum required front setback lines are:
 - Expressway, Parkway or Primary Thoroughfare = 40 feet from proposed right-of-way.
 - Secondary Thoroughfare = 30 feet from proposed right-of-way.
 - Collector = 30 feet from existing right-of-way or 60 feet from centerline whichever is greater.
 - Local, Marginal Access = 25 feet from existing right-of-way.
 - Vehicular turnaround of a Cul-de-sac = 20 feet from existing right-of-way.

This table is a summary only and does not include all standards. Refer to the actual ordinance for the complete standards.

Summary of Selected Development Standards For Multifamily and Mobile Dwelling Districts

| District | Minimum Street Frontage | Minimum Setback | | Maximum Building Height | | Development Amenities Ratios | | | | | |
|--------------|-------------------------|-----------------|--------|-------------------------|-----------|------------------------------|-------|-------|-------|-------|-------|
| | | Side | Rear | Primary | Accessory | FAR | OSR | LSR | MLSR | TCR | |
| D-6 | 150 feet | 30 ft. | 30 ft. | 35 ft. | 25 ft. | 0.200 | 3.850 | 2.600 | 0.180 | 1.600 | |
| D-6II | 150 feet | 25 ft. | 25 ft. | 35 ft. | 25 ft. | 0.280 | 2.650 | 1.650 | 0.160 | 1.500 | |
| D-7 | 150 feet | 20 ft. | 20 ft. | 35 ft. | 25 ft. | 0.350 | 2.100 | 1.250 | 0.140 | 1.400 | |
| D-8 | 30 feet | 10 ft. | 15 ft. | 35 ft. | 25 ft. | 0.600 | 1.180 | 0.660 | 0.110 | 1.000 | |
| D-9 | 1 – 3 stories | 150 feet | 20 ft. | 20 ft. | Unlimited | 25 ft. | 0.500 | 1.450 | 0.040 | 0.120 | 1.200 |
| | 4 – 5 stories | 150 feet | 20 ft. | 20 ft. | Unlimited | 25 ft. | 0.800 | 0.870 | 0.490 | 0.095 | 1.000 |
| | 6 -11 stories | 150 feet | 20 ft. | 20 ft. | Unlimited | 25 ft. | 1.500 | 0.450 | 0.290 | 0.071 | 1.000 |
| | 12 stories and over | 150 feet | 20 ft. | 20 ft. | Unlimited | 25 ft. | 2.200 | 0.290 | 0.200 | 0.054 | 1.000 |
| D-10 | 1 – 3 stories | 100 feet | 20 ft. | 20 ft. | Unlimited | 25 ft. | 0.600 | 1.180 | 0.660 | 0.110 | 1.000 |
| | 4 – 5 stories | 100 feet | 20 ft. | 20 ft. | Unlimited | 25 ft. | 0.800 | 0.870 | 0.490 | 0.095 | 0.940 |
| | 6 -11 stories | 100 feet | 20 ft. | 20 ft. | Unlimited | 25 ft. | 1.500 | 0.450 | 0.290 | 0.071 | 0.750 |
| | 12 – 23 stories | 100 feet | 20 ft. | 20 ft. | Unlimited | 25 ft. | 3.00 | 0.280 | 0.190 | 0.052 | 0.750 |
| | 24 stories and over | 100 feet | 20 ft. | 20 ft. | Unlimited | 25 ft. | 3.200 | 0.270 | 0.190 | 0.050 | 0.750 |

Note: Minimum required front setback lines are:

- Expressway, Parkway or Primary Thoroughfare = 40 feet from proposed right-of-way.
- Secondary Thoroughfare = 30 feet from proposed right-of-way.
- Collector = 30 feet from existing right-of-way or 60 feet from centerline whichever is greater.
- Local, Marginal Access = 25 feet from existing right-of-way.
- Vehicular turnaround of a Cul-de-sac = 20 feet from existing right-of-way.

This table is a summary only and does not include all standards. Refer to the actual ordinance for the complete standards.